



kladfix

high quality • value • cladding systems

KLADFIX







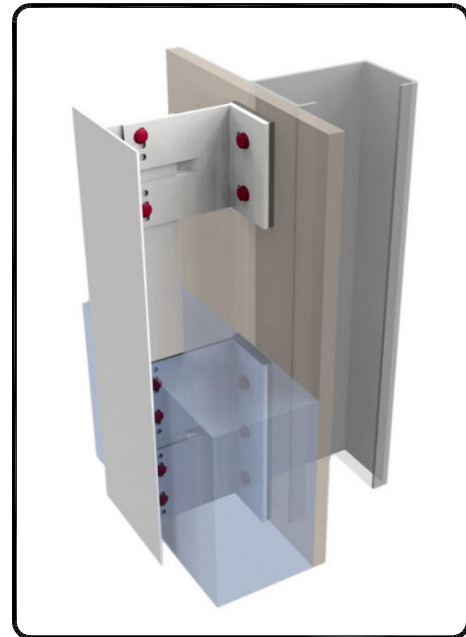





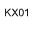

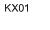
LEGEND:

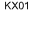
- A - Cladding Material
- B - Cladding-rivet
- C - PTS Screws (length to suit panel thickness)
- D - SIKA Adhesive system

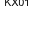
- 1 - SFS steel wall + cement board
- 2 - Kladfix - support bracket
- 3 - Stainless steel fixing Kladfix
- 4 - T-(L) profile vertical Kladfix
- 5 - Self drilling stainless steel screw SR2 4.2 x 16
- 6 - Horizontal rail Kladfix
- 7 - Thermal insulation
- 8 - Ventilation Cavity
- 9 - Self drilling stainless steel screw SR2 4.8 x 19
- 10 - Kladfix Thermal isolator
- 11 - Timber carrier 50mm wide Kladfix
- 12 - Timber carrier 100mm wide Kladfix
- 13 - Timber fixings 4.8 x 25
- 14 - KX07 vertical rail - Kladfix
- 15 - KX07 J support clip - Kladfix

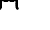

CONTENTS:

- KX01 =  +  Drawing No :- Kladfix 10-11-12-13-14
- KX02 =  +  Drawing No :- Kladfix 20-21-22-23-24
- KX03 =  +  Drawing No :- Kladfix 30-31-32
- KX04 =  +  Drawing No :- Kladfix 40-41-42
- KX05 =  +  Drawing No :- Kladfix 50-51-52-53
- KX06 =  +  Drawing No :- Kladfix 60-61-62-63
- KX07 =  +  +  Drawing No :- Kladfix 70-71-72-73

System:- KX01

kladfix

aluminium support system for
rainscreen cladding

KLADFIX KX01 SYSTEM

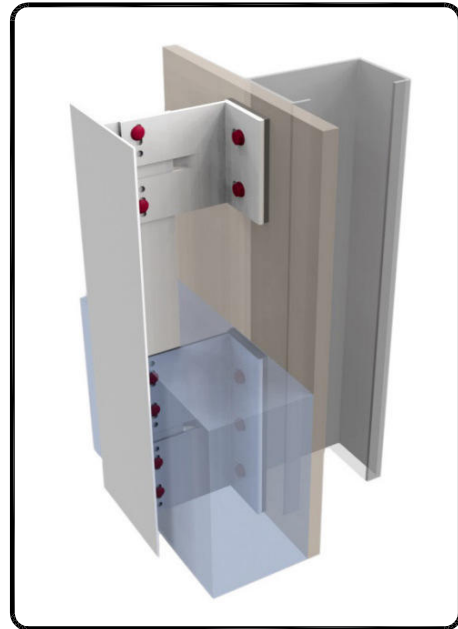

Kladfix bracket- SINGLE	6.5 mm hole	11.00 mm hole
60	KXV060S-6.5	KXV060S-11
90	KXV090S-6.5	KXV090S-11
120	KXV120S-6.5	KXV120S-11
150	KXV150S-6.5	KXV150S-11
180	KXV180S-6.5	KXV180S-11
210	KXV210S-6.5	KXV210S-11
ISOLATOR SINGLE	KX-S-ISO	KX-S-ISO
Kladfix bracket DOUBLE	6.5 mm hole	11.00 mm hole
60	KXV060D-6.5	KXV060D-11
90	KXV090D-6.5	KXV090D-11
120	KXV120D-6.5	KXV120D-11
150	KXV150D-6.5	KXV150D-11
180	KXV180D-6.5	KXV180D-11
210	KXV210D-6.5	KXV210D-11
ISOLATOR DOUBLE	KX-D-ISO	KX-D-ISO
Kladfix Rail	Rail Code	
50 x 50 x 2.2 L	KXL50-50-2.2-3000	3000 = 3 metre length, can also be 6000 = 6 metre length, 4850=4.85 metre length
50 x 100 x 2.2 T	KXT50-100-2.2-3000	3000 = 3 metre length, can also be 6000 = 6 metre length, 4850=4.85 metre length
Additional rails		
60 x 40 x 2.2 L	L60-040-2.2-3000	3000 = 3 metre length, can also be 6000 = 6 metre length, 4850=4.85 metre length
60 x 80 x 2.2 T	T60-080-2.2-3000	3000 = 3 metre length, can also be 6000 = 6 metre length
60 x 100 x 2.2 T	T60-100-2.2-3000	3000 = 3 metre length, can also be 6000 = 6 metre length, 4850=4.85 metre length
120 x 60 x 2.2 T	T60-120-2.2-3000	3000 = 3 metre length, can also be 6000 = 6 metre length, 4850=4.85 metre length
140 x 60 x 2.2 T	T60-140-2.2-3000	3000 = 3 metre length, can also be 6000 = 6 metre length
Fixings	fixing ref	
SR2 4.2 x 16	4.2-16	rail to bracket
JT3 6.3 x 25	JT3-2-6.3X25S16	metsec steel frame with no cement board or folded omega
JT3 6.3 x 38	JT3-3-6.3X38S16	metsec steel frame with up to 12mm cement board
JT3 6.3 x 50	JT3-3-6.3X50S16	metsec steel frame with up to 18mm cement board
SDF 10 x 60	SDF-KB-10H-60	to block / concrete dependent on block strength thickness
SDF 10 x 80	SDF-KB-10H-80	to block / concrete dependent on block strength thickness
SDF 10 x 100	SDF-KB-10H-100	to block / concrete dependent on block strength thickness

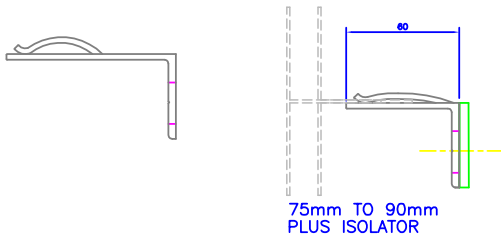
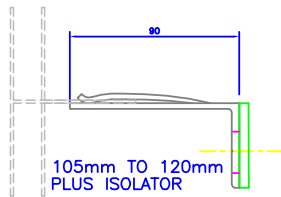
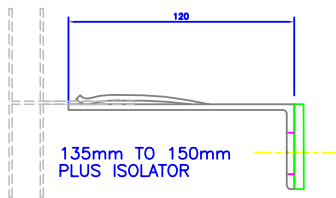
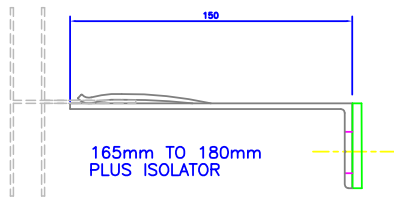
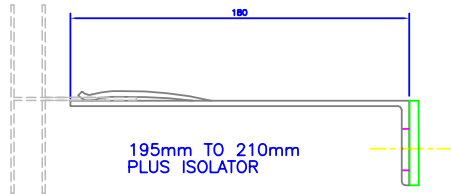
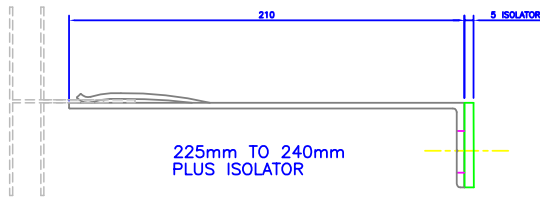

HORIZONTAL SECTIONS
TOLERANCES FOR ADJUSTMENT
WITH OUT ISOLATOR WITH ISOLATOR
ADD 5mm TO ALL DIMENSIONS

BRACKETS	Adjustment range for each bracket (mm)		
KLADFIX 60	from 75	to 90	50 x 50 L
KLADFIX 90	from 105	to 120	
KLADFIX 120	from 135	to 150	100 x 50 T
KLADFIX 150	from 165	to 180	
KLADFIX 180	from 195	to 210	
KLADFIX 210	from 225	to 240	

BRACKETS	Adjustment range for each bracket (mm) 40 leg in bracket		
KLADFIX 60	from 62	to 80	60 x 40 L
KLADFIX 90	from 92	to 110	
KLADFIX 120	from 122	to 140	100 x 40 T
KLADFIX 150	from 152	to 170	
KLADFIX 180	from 182	to 200	
KLADFIX 210	from 212	to 230	

BRACKETS	Adjustment range for each bracket (mm) 60 leg in bracket		
KLADFIX 60	from 86	to 100	60 x 40 L
KLADFIX 90	from 115	to 130	
KLADFIX 120	from 145	to 160	100 x 60 T 120 x 60 T
KLADFIX 150	from 175	to 190	
KLADFIX 180	from 205	to 220	
KLADFIX 210	from 235	to 250	

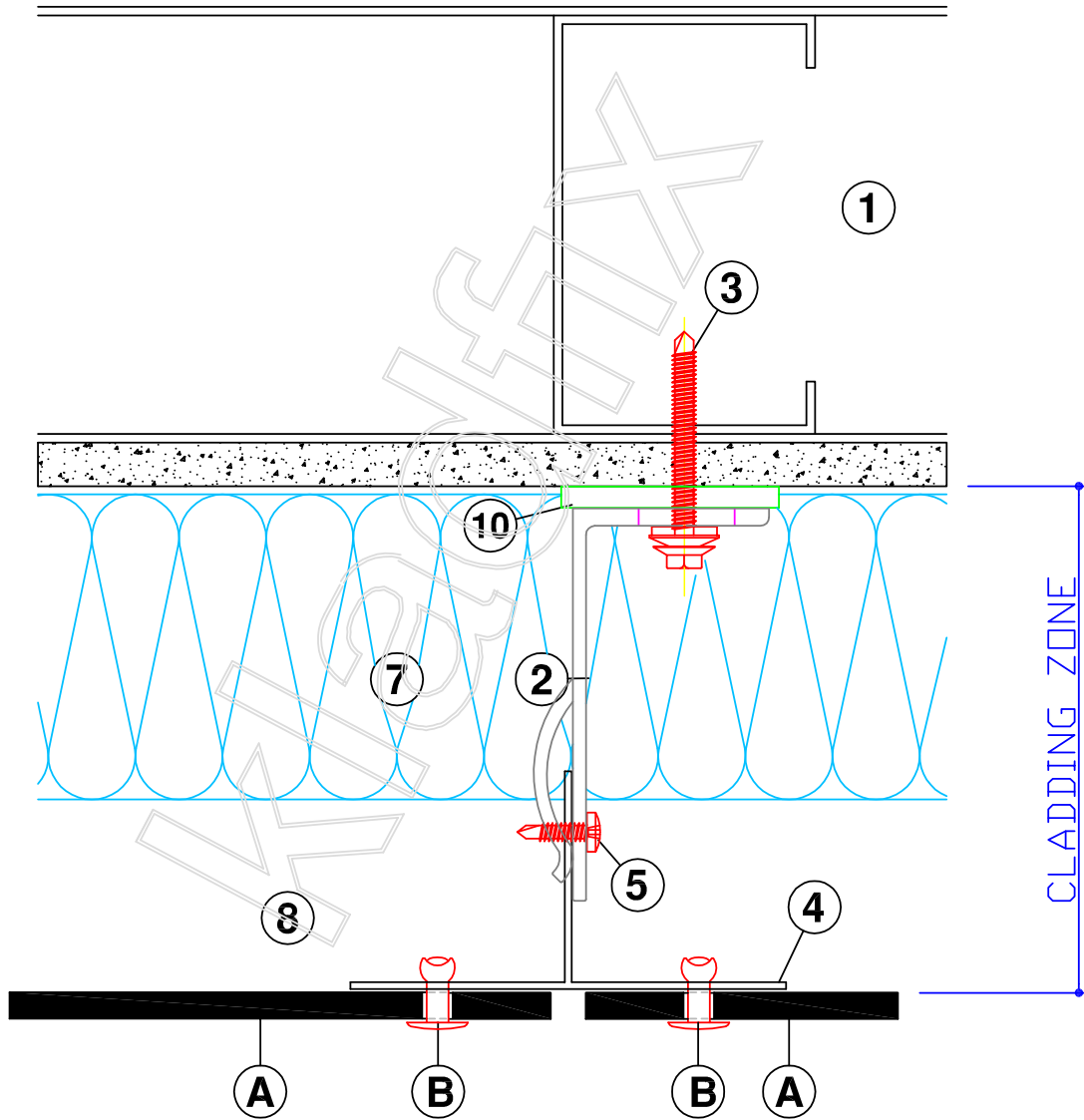

HORIZONTAL SECTION - KLADFIX 90

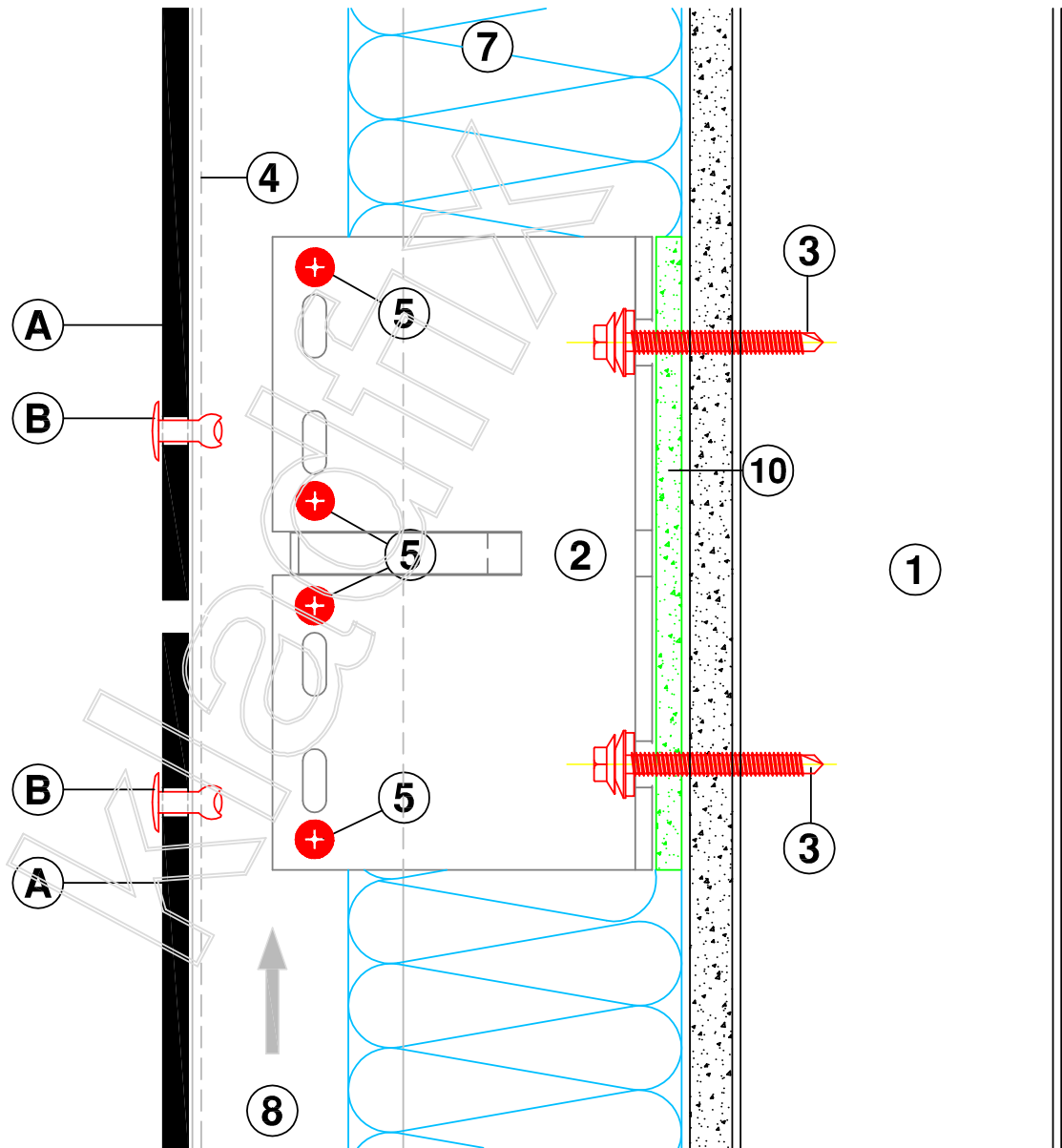

VERTICAL SECTION - KLADFIX 90 DOUBLE FIXED POINT

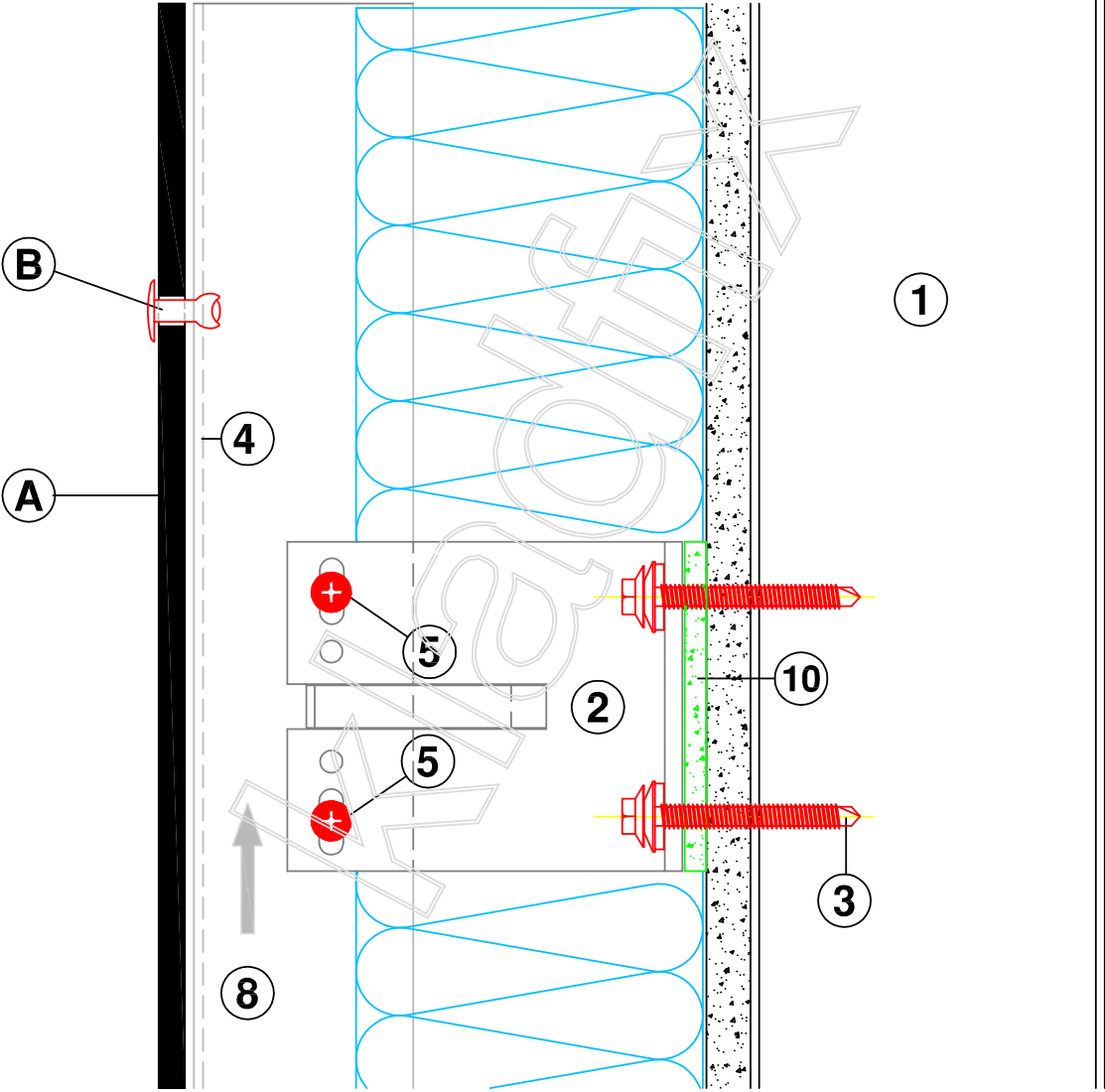

VERTICAL SECTION - KLADFIX 90 SINGLE FLOATING POINT